

BUILDING FOOTPRINT COVERAGE COMPARISON TABLE			
BLDG NO.	PD DEVELOPMENT PLAN BLDG FOOTPRINT COVERAGE (SF)	CURRENT PLAN BLDG FOOTPRINT COVERAGE (SF)	DIFFERENCE
1	11,574	11,887	293
2	11,574	11,887	293
3	11,574	12,984	1,410
4	14,894	15,210	316
5	14,894	15,210	316
6	11,574	12,984	1,410
7	14,894	15,210	316
8	14,894	15,210	316
CLUB & AMENITY AREA	14,126	5,636	(8,490)
TOTAL	119,997	116,178	(3,819)

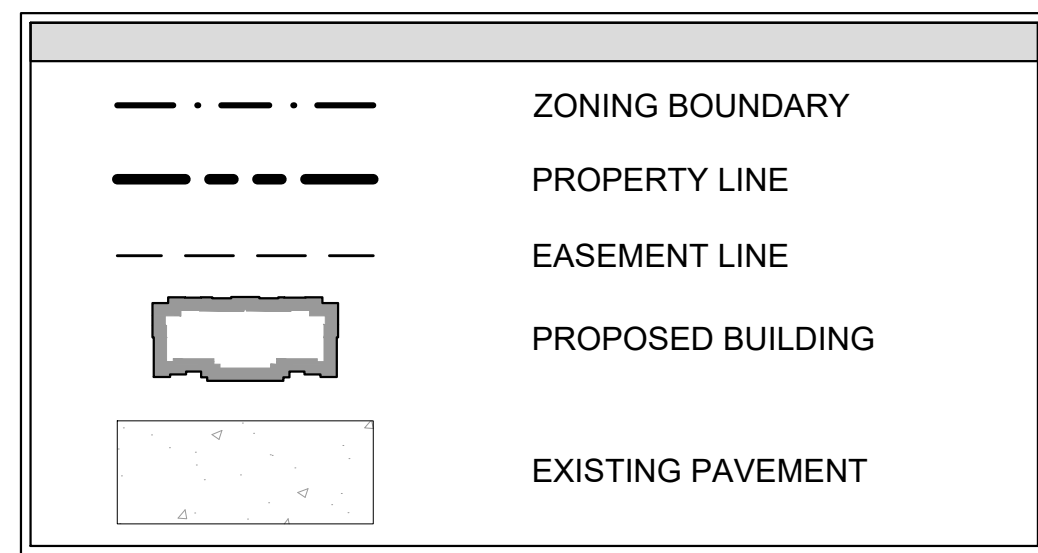
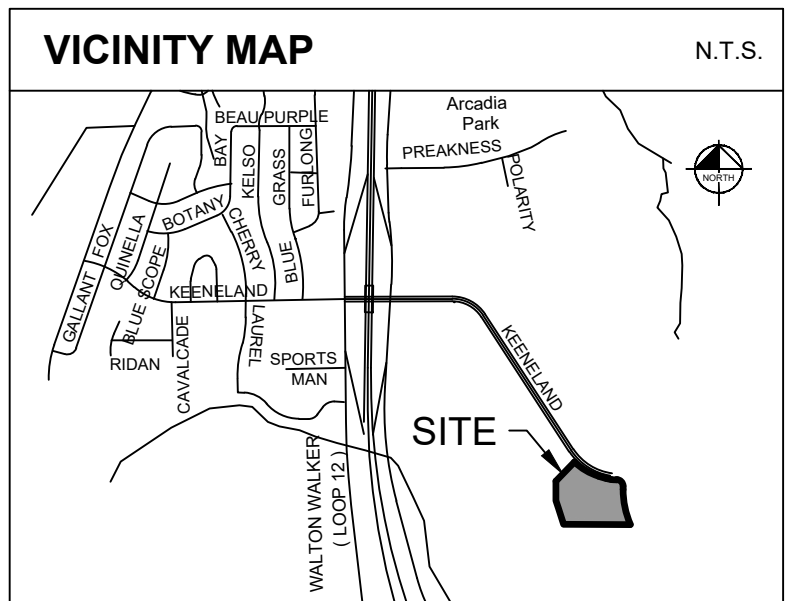
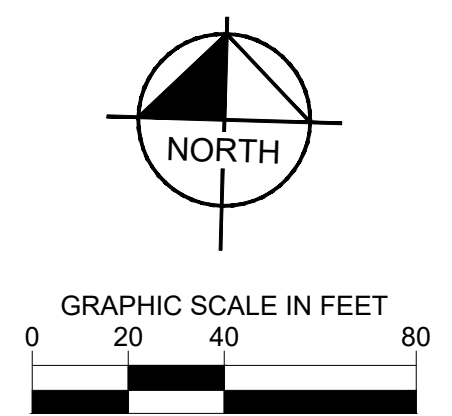

SITE DATA	
GENERAL SITE DATA	
LOCATION	5050 KEENE LAND PKWY
PD	PD DISTRICT NO. 247
ZONING CASE	ORDINANCE NO. 31736
SUB AREA	CASE: Z012-210/6600-SW(RB)
LAND AREA	TRACT 3A
MULTI-FAMILY BUILDING COVERAGE	12.94 ACRES
CLUB, LEASING OFFICE, FITNESS, MODEL UNIT, AND PUMP HOUSE BUILDING COVERAGE	110,542 SF
TOTAL BUILDING COVERAGE AREA	5,636 SF
TOTAL BUILDING COVERAGE AREA	116,178 SF
RESIDENTIAL DENSITY	336 UNITS
LOT COVERAGE PERCENTAGE	21%
PARKING	
PARKING REQUIRED	1.7 SPACE/UNIT
TOTAL PARKING REQUIRED	572
COVERED PARKING PROVIDED	137
UNCOVERED PARKING PROVIDED	437
TOTAL PARKING PROVIDED	574
BICYCLE PARKING PROVIDED	30 SPACES
BICYCLE PARKING PROVIDED	35 SPACES
BUILDING	
MAXIMUM BUILDING HEIGHT	36 FT
BUILDING STORIES	3

TOTAL UNIT MIX	
TOTAL 1 BEDROOM UNITS	72
TOTAL 2 BEDROOM UNITS	216
TOTAL 3 BEDROOM UNITS	48
TOTAL UNITS	336

**TRACT 3A
PLANNED DEVELOPMENT
DISTRICT NO. 247
DEVELOPMENT PLAN
MINOR AMENDMENT
M201-037**

DATE	
REVISIONS	
NO.	

© 2021 KIMLEY-HORN
13435 NOEL ROAD, TWO GALLERIA OFFICE TOWER, SUITE 700
DALLAS, TEXAS 75240
PHONE: 972.770.1900, FAX: 972.293.5820
TEXAS REGISTERED ENGINEERING FIRM F-928

**AHS DALLAS NATIONAL
MULTI-FAMILY
CITY OF DALLAS, TEXAS**

**TRACT 3A
DEVELOPMENT PLAN
MINOR AMENDMENT**

SHEET NUMBER
1 OF 1